

No. 252

County

Cabarrus

Name

Jarrett Jms.

Acres

145--

Grant No.

313

Issued

7th Dec, 1804

Warrant No.

Entry No.

1483

Entered

25 April 1791

Book No.

113

Page No.

87

Location

on head waters
of Dutch Run

Remarks:

State of North Carolina.

To the Surveyor of Cabarrus County Greeting.

You are hereby required as soon as may be to lay off & Survey for John Jarrett a Tract or parcel of Land lying & being now in the County of Cabarrus containing 200 Acres On the waters of Buffalo Creek joins Hugh Waddles Land on the South Michael Goodman John Lippard & John Edelman & On the North of William Leopard entered the 25th Day of April 1791 No 1483

Observing the directions of an Act of Assembly in such Case made and provided for running of Lands two Just and fair plans of such Survey with a proper Certificate annexed to each. you are to transmit ~~with~~ this warrant to the Secretarys office without Delay Given under my hand by order of Court at October Sessions
- Inno Dorn 1804

Jesse Alexander Clerk

This is a duplicate warrant
issued by order of Court J.

No. 1488

To the Sheriff

Duplicate Warrant

Cabarrus

Mecklenburg County

Alias Cabarrus County

of and to bring
Grant for the return

Octo 29th 1804

Geo

No. 313 date

7th Dec. 1804

Wm. Caldwell

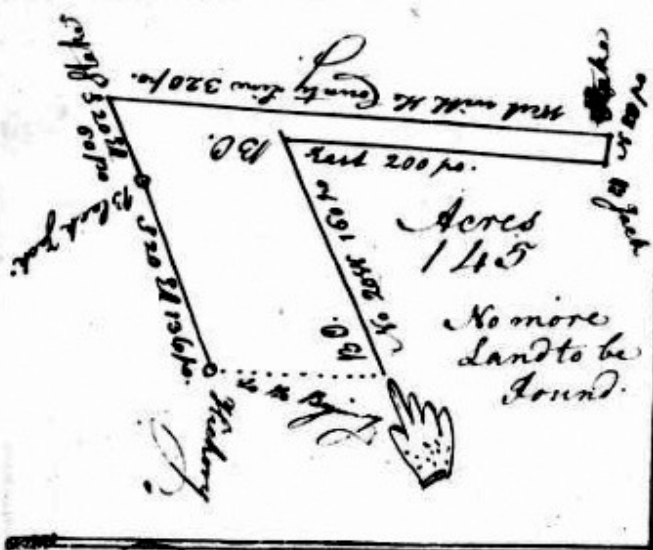

State of North
 Carolina Cabarrus
 County.
 Surveyed for John
 Garrett One Hundred
 and Forty five Acres of
 Land in Cabarrus
 County on the head waters

of Dutch Buffalo Beginning at a
 Black Oak Waddles and Edelmanns Corner, Thence
 with Edelmanns Line North Twenty degrees West, One
 Hundred & sixty poles to a Black oak, Edelmanns Corner, Thence
 with said Line East Two Hundred poles to a Stake thence
 North Twenty poles to a stake on the County Line, thence with
 the County Line West Three Hundred and Twenty poles
 to a Stake. Thence South twenty degrees East Sixty poles to
 a Black Jack, Sifferts Last Corner, thence with Sifferts Line
 South Twenty degrees East One Hundred & Thirty six poles
 to a Hickory Sifferts Corner, Thence to the
 Beginning

Surveyed the 29th October 1804

Chain Bearers
 William Siffert
 George Siffert

John Alexander